

# The Light Source

## Mega-Track Hanger Short

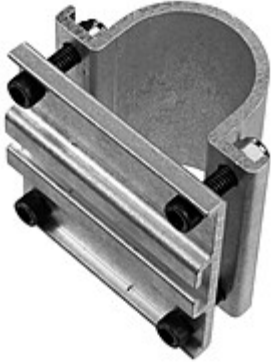

The Mega-Track Hanger makes it easy to hang 140 or 300 series track onto pipe grids, or from individual pipes. There are two versions of the Mega-Track Hanger.

The Mega-Track Hanger Short hangs from the lower pipe of the grid and secures the track just  $\frac{3}{16}$  of an inch below the grid pipe. The Mega-Track Hanger Long hangs from the upper pipe of the grid and has an offset length from the track to the pipe the diameter of the bottom grid pipe plus  $\frac{3}{16}$  of an inch.

The Mega-Track hanger Long has two different track hanging slots so that it will work with either 1-1/2" or 1-1/4" schedule 40 pipe grids. Both of the Mega-Track Hangers use a Mega-Gridlock half to fasten over the pipe and secure from below with four 5/16" socket head screws. The Mega-Gridlock half has slots along the edge that act like a wrench to hold the four Nylock nuts from turning during installation. Only a slight downward pressure with your fingers is required to hold a nut in place for installation. The track hanger slides over the track prior to placing the track in position. Support track approximately every 4 feet.

The Mega-Track Hanger Short can be used on 2" truss. Since the truss has a larger OD than 2" pipe, a rubber mallet can be used to make it fit on the truss.

<b>Minimum Size</b>	1-1/4" pipe (1.66 OD)
<b>Maximum Size</b>	2.050 OD Truss Tube
<b>Working Load Limit</b>	300 Pounds
<b>Dimensions</b>	3.65" x 3.65"
<b>Weight</b>	.93 lbs.
<b>Case Quantities</b>	12
<b>Order Codes</b>	<b>MTSM</b> Mega-Track Hanger, Short, Silver <b>MTSB</b> Mega-Track Hanger, Short, Black Anodized